

a m e r i c a n d r e w™

# PROFILES

f u r n i t u r e d e s i g n e d f o r l i v i n g



a m e r i c a n  d r e w®  
a L A Z B O Y company

4310 Regency Drive, Suite 101  
High Point, NC 27265  
www.americandrew.com  
© 2010 by American Drew

AD/FCC/WCP/06-10/5M

**CAMDEN LIGHT FINISH**  
SERIES 920

a m e r i c a n d r e w™  
**PROFILES**  
furniture designed for living

Subtle style references and approachable scale enable you to reflect a unique sense of personal style while satisfying your desire for comfort, convenience, and quality. And, like a clean canvas, PROFILES invites an infinite range of accessorization, allowing you to add the accessories and personal possessions that express who you are, fashioning the perfect home for your individual life.

That's what PROFILES is all about—  
furniture that fits your life!



## CAMDEN LIGHT FINISH

Camden accents simple forms with quiet traditional references, gentle curves and a beautiful time worn white finish that lets the character of the wood show through. The brushed nickel finish hardware adds even more casual elegance to Camden. This collection will work great in your renovated farm house or that smaller beach cottage get-away.

920-595  
DESK - RTA  
W51 D22 H31

920-636  
SPLAT SIDE CHAIR  
W20 D24 H39  
Seat H20



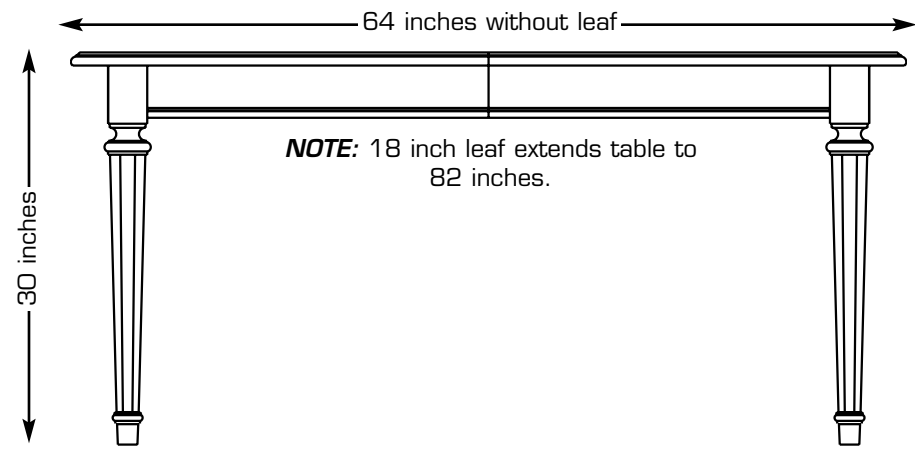

**920-760**  
**LEG TABLE**



Table Top Detail  
Without Leaf



Table Top Detail  
With Leaf

*Right:*  
**920-636**  
**SPLAT SIDE CHAIR - KD**  
W20 D24 H39  
Seat H20

**920-637**  
**SPLAT ARM CHAIR - KD**  
W23 D24 H39  
Seat H20 Arm H25

**920-760**  
**LEG TABLE - RTA**  
L64 W42 H30  
(1) 18" Leaf  
Extends Table to 82"  
(Shown with leaf)

**920-830R**  
**CHINA**  
W63 D20 H82  
*Consists of:*  
**-831 China Deck**  
W63 D20 H48  
**-830 China Buffet/Credenza**  
W60 D19 H34

"We love to cook and have friends over and the Camden Leg Table seats us all comfortably."





*Above:*  
**920-015**  
**ROUND MIRROR**  
 W39 D3 H39  
 Beveled Mirror.

**920-890**  
**SERVER**  
 W40 D18 H38  
 2 Drawers, 1 Pullout Shelf,  
 1 Door with 1 Adjustable  
 Shelf, Stationary Wine  
 Storage, Silver Tray.



*Right:*  
**920-830R**  
**CHINA**  
 W63 D20 H82  
 Consists of:

- 831 China Deck**  
 W63 D20 H48  
 3 Doors, 6 Adjustable Glass Shelves,  
 3 Can Lights, Mirrored Back,  
 Touch Lighting.
- 830 China Buffet/Credenza**  
 W60 D19 H34  
 2 Glass Doors with 1 Adjustable Glass  
 Shelf in Each, 3 Drawers, Silver Tray,  
 2 Can Lights, Touch Lighting.



**920-706R  
ROUND BAR HEIGHT PED  
TABLE**

L42 W42 H41

*Consists of:*

**-706 Round Table Top**

L42 W42 H4

**-B02 Bar Height Ped Table**

Base - RTA

W32 D32 H40

**920-691**

**BAR STOOL - BAR HEIGHT - KD**

W18 D21 H45

Seat H30



*Above & Left:*

**920-582**

**FLIP TOP BAR**

W39 D22 H43

(99 x 56 x 109cm)

2 Doors, Bottle Storage,

1 Drawer, Wine Storage,

Black Laminate on Flip Top,

Casters on Bottom.



**920-890  
SERVER**

W40 D18 H38  
2 Drawers, 1 Pullout Shelf,  
1 Door with 1 Adjustable  
Shelf, Stationary Wine  
Storage, Silver Tray.

**920-707R  
ROUND COUNTER HEIGHT  
PED TABLE**

L42 W42 H35

*Consists of:*

**-706 Round Table Top**

L42 W42 H4

**-B03 Counter Height Ped  
Table Base - RTA**

W32 D32 H34

**920-690  
BAR STOOL - COUNTER  
HEIGHT - KD**

W18 D21 H39

Seat H25



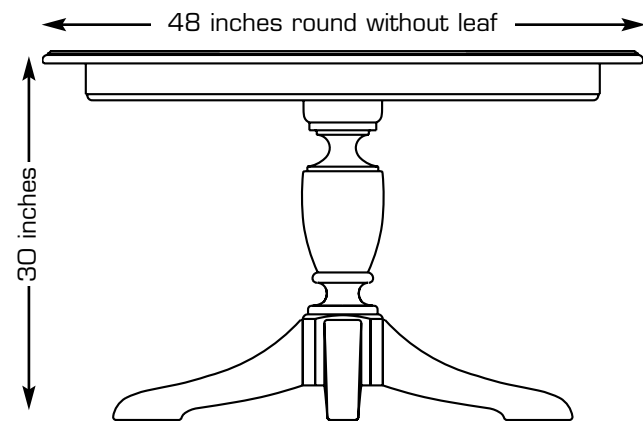

**920-701R**  
**ROUND TABLE**

**NOTE:** 16 inch leaf extends table to 64 inches..



Table Top Detail  
Without Leaf



Table Top Detail  
With Leaf

*Right:*  
**920-015**  
**ROUND MIRROR**  
W39 D3 H39  
Beveled Mirror.

**920-890**  
**SERVER**  
W40 D18 H38  
2 Drawers, 1 Pullout Shelf,  
1 Door with 1 Adjustable  
Shelf, Stationary Wine  
Storage, Silver Tray.

**920-701R**  
**ROUND TABLE**  
L48 W48 H30  
(1) 16" Leaf  
Extends Table to 64".  
(Shown with leaf)

**920-636**  
**SPLAT SIDE CHAIR**  
W20 D24 H39  
Seat H20

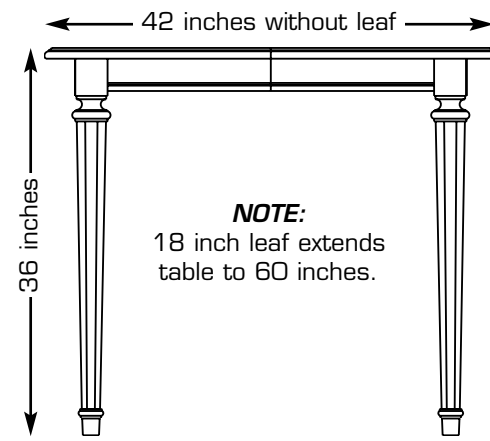



Table Top Detail  
Without Leaf



Table Top Detail  
With Leaf



**920-705**  
**GATHERING TABLE**

**NOTE:** The 705 Gathering Table  
can make a great office desk set  
up as well.



"I love my Camden  
Gathering Table for  
Casual dining or set  
up with my laptop as  
a home work area, it  
fits both perfectly."

*Right:*  
**920-705**  
**GATHERING TABLE**  
L60 W42 H36  
(1) 18" Leaf  
Extends Table to 60" x 60"  
(Shown without leaf)

**920-690**  
**BAR STOOL - COUNTER**  
**HEIGHT - KD**  
W18 D21 H39  
Seat H25

**920-588**  
**BOOKCASE/CHINA**  
W52 D19 H80







*Left:*  
**920-691**  
**BAR STOOL -**  
**BAR HEIGHT - KD**  
W18 D21 H45  
Seat H30

**920-690**  
**BAR STOOL -**  
**COUNTER HEIGHT - KD**  
W18 D21 H39  
Seat H25



*Left:*  
**920-636**  
**SPLAT SIDE CHAIR - KD**  
W20 D24 H39  
Seat H20

**920-637**  
**SPLAT ARM CHAIR - KD**  
W23 D24 H39  
Seat H20  
Arm H25



*Right:*  
**920-589**  
**BOOKCASE/BAR**  
W38 D18 H42  
2 Drawers, Glass Fold Up  
Door with Wine Glass  
Storage on LSF, Open  
Compartment on RSF, Glass  
Fold Up Door with Removable  
Wine Rack on Bottom.

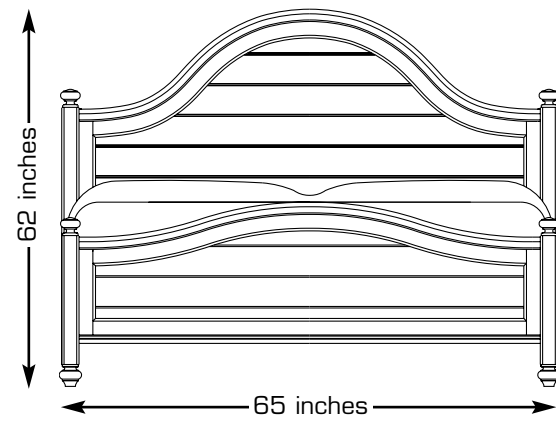

**920-313R  
PANEL BED 5/0**

**NOTE:** Panel Bed Available in  
Additional Sizes.  
See Page 47 for details.



*Right:*  
**920-313R  
PANEL BED 5/0**

*Consists of:*

- 313 Panel Headboard 4/6-5/0**  
W65 D4 H62
- 314 Panel Footboard 4/6-5/0**  
W65 D4 H29
- R42 Wooden Rails 5/0-6/6**  
W82 D2 H8
- SK1 Mattress Support System**

**920-401  
LEG NIGHTSTAND - RTA**

W26 D19 H28  
1 Drawer, 1 Shelf, Pullout Shelf  
with Black Laminate.

*Right:*  
**920-215**  
**DRAWER CHEST**  
W38 D19 H52  
5 Drawers.



“Camden creates that relaxed feel I want in my bedroom.”

*Right:*  
**920-230**  
**CORNER CHEST**  
W42 D20 H50  
5 Drawers.



**920-020**  
**LANDSCAPE MIRROR**  
W41 D2 H36  
Beveled Mirror.

**920-220**  
**DRESSING CHEST**  
W62 D20 H39  
9 Drawers.



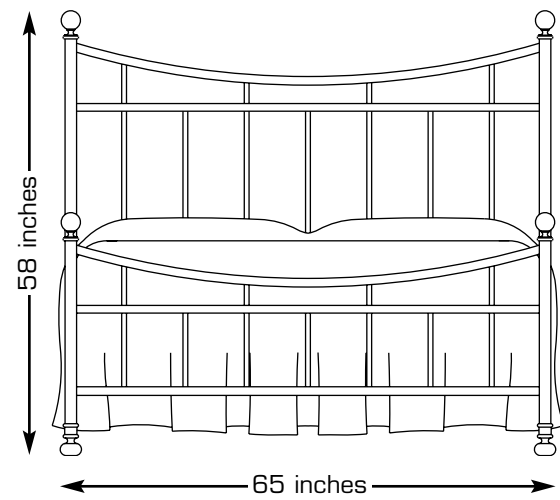

**920-395NR  
METAL BED 5/0  
NICKEL FINISH**

**NOTE:** Metal Bed Available in Additional Sizes. See Page 47 for details.

*Right:*  
**920-395NR  
METAL BED 5/0  
NICKEL FINISH**

*Consists of:*

**-395N Metal Bed 5/0**  
W65 D3 H58

**-R95N Metal Rails 5/0**  
W82 D2 H8

**920-401  
LEG NIGHTSTAND - RTA**  
W26 D19 H28

1 Drawer, 1 Shelf, Pullout Shelf with Black Laminate.



*Right:*  
**920-015**  
**ROUND MIRROR**  
W39 D3 H39  
Beveled Mirror.

**920-221**  
**DRESSER**  
W56 D19 H37  
7 Drawers.

**920-310R**  
**PANEL BED 3/3**  
*Consists of:*  
**-310 Panel Headboard 3/3**  
W43 D3 H53  
Bored for Frame.  
**-311 Panel Footboard 3/3**  
W43 D3 H28  
**-R40 Wood Rails with**  
**Slats 3/3**  
W76 D2 H8

**920-401**  
**LEG NIGHTSTAND - RTA**  
W26 D19 H28  
1 Drawer, 1 Shelf, Pullout Shelf  
with Black Laminate.

**NOTE:** Panel Bed Available in  
Additional Sizes.  
See Page 47 for details.



*Right:*  
**920-401**  
**LEG NIGHTSTAND - RTA**  
W26 D19 H28  
1 Drawer, 1 Shelf, Pullout Shelf  
with Black Laminate.

**920-390NR**  
**METAL BED 3/3**  
**NICKEL FINISH**  
*Consists of:*  
**-390N Metal Bed 3/3**  
W43 D3 H58  
**-R90N Metal Rails 5/0**  
W76 D2 H8

**920-015**  
**ROUND MIRROR**  
W39 D3 H39  
Beveled Mirror.

**920-221**  
**DRESSER**  
W56 D19 H37  
7 Drawers.

**NOTE:** Metal Bed Available in  
Additional Sizes.  
See Page 45 for details.





**920-270R  
ARMOIRE**  
Shown as Storage.



**920-270R  
ARMOIRE**  
Shown with Hanging Rod.



**920-270R  
ARMOIRE**  
Shown as Entertainment.

**920-270R  
ARMOIRE**  
W46 D24 H73  
*Consists of:*

- 271 Armoire Deck**  
W46 D24 H48  
2 Wraparound Doors,  
2 Adjustable Shelves,  
Clothes Rod, Sliding  
Back Panel, 1 Fixed  
Shelf, 2 Open  
Compartments:  
W19 D19 H6  
TV Outlet Box.  
TV Opening:  
W39 D20 H37
- 270\* Armoire Base**  
W43 D22 H25  
5 Drawers.



*Right:*  
**920-910**  
**COCKTAIL TABLE**  
W48 D24 H19  
2 Pull Through Drawers,  
4 Baskets.

**920-915**  
**SIDE TABLE**  
W23 D20 H25  
2 Drawers, 1 Basket.



“Bright and airy,  
comfy and casual,  
that is what we like  
and Camden fits  
that.”







Above:  
**920-401**  
**LEG NIGHTSTAND - RTA**  
 W26 D19 H28  
 1 Drawer, 1 Shelf, Pullout  
 Shelf with Black Laminate.

**NOTE:** Nightstands and End  
 Tables can be interchanged.

Above:  
**920-915**  
**SIDE TABLE**  
 W23 D20 H25  
 2 Drawers, 1 Basket.



Right:  
**920-925**  
**CONSOLE TABLE**  
 W48 D16 H30  
 4 Drawers,  
 4 Baskets,  
 2 Adjustable Shelves.

Left:  
**920-940**  
**WALL STORAGE - RTA**  
 W34 D19 H76  
 5 Shelves.



“The scale of Camden was perfect for our home and we did not have to sacrifice the style we wanted.”

Left:  
**920-585**  
**48" ENTERTAINMENT CENTER**  
 W48 D24 H28  
 2 Doors with Adjustable Shelf Behind Each, 2 Adjustable Shelves and 1 Fixed Shelf in Center.



**920-588**  
**BOOKCASE/CHINA**  
 W52 D19 H80  
 2 Sliding Doors, 2 Tray Drawers, 3 Adjustable Glass Shelves, 2 Can Lights.

**NOTE:** The 588 Bookcase/China works well in an occasional or dining area.



**NOTE:** Multiple pieces used to create a full wall unit.

**Overall Dimensions as shown:**  
 Width: 112"  
 Depth: 22"  
 Height: 75"

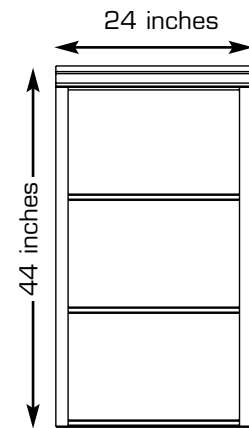

**920-581  
 END UNIT TOP**

**NOTE:** Two 920-581 End Unit Tops used.

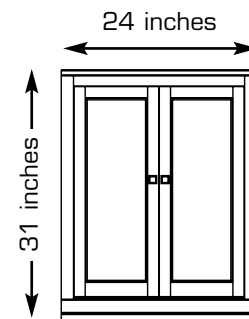

**920-580  
 END UNIT BASE**

**NOTE:** Two 920-580 End Unit Bases used.

*Right:*

**920-581**

**END UNIT TOP**

W24 D17 H44

2 Adjustable Wooden Shelves,  
 1 Fixed Shelf.  
 (2 Shown)

**920-580**

**END UNIT BASE**

W24 D22 H31

2 Doors with 2 Adjustable Half  
 Shelves Behind Each.  
 (2 Shown)

**920-583**

**64" ENTERTAINMENT CENTER**

W64 D22 H25

2 Doors with Fixed Half Shelf  
 Behind Each, 2 Adjustable  
 Shelves and 1 Fixed Shelf in  
 Center.

**920-591**

**64" STORAGE BRIDGE**

W64 D17 H14

3 Open Compartments.

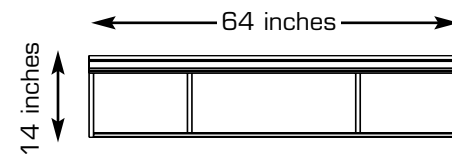

**920-591  
 STORAGE BRIDGE**

**NOTE:** Storage Bridge offered  
 in smaller size as 920-590.  
 See Page 35 for details.

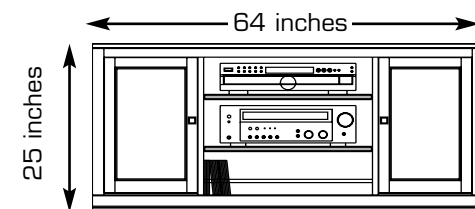

**920-583  
 64" ENTERTAINMENT CENTER**

**NOTE:** Entertainment Center offered  
 in smaller size as 920-584.  
 See Page 47 for details.





Above:  
**920-586**  
**64" ENTERTAINMENT CENTER**  
 W64 D24 H28  
 2 Double Doors with 1  
 Adjustable Shelf Behind Each,  
 2 Adjustable Shelves and  
 1 Fixed Shelf in Center.

**NOTE:** Camden offers multiple options  
 and sizes for Entertainment pieces.



Above:  
**920-940**  
**WALL STORAGE - RTA**  
 W34 D19 H76  
 5 Shelves.

**920-946**  
**56" ENTERTAINMENT CENTER - RTA**  
 W56 D23 H29  
 2 Fixed Shelves,  
 Top Opening: W52 D19 H7  
 Bottom Opening: W52 D22 H13



*Above & Right:*  
**920-942**  
**HOME WORK STATION**  
 W48 D23 H39  
 3 Drawers, Fold Down Front  
 Center Drawer, Pencil Tray,  
 Power Bar, 2 Doors with 3  
 Tray Drawers Behind Each,  
 File Storage in Each Bottom  
 Drawer.

**920-943**  
**HOME WORK STATION DECK**  
 W51 D15 H44  
 4 Bi-Fold Doors with 3  
 Adjustable Shelves, Removable  
 Charging Station, Power Bar,  
 Wire Management. Openings:  
 Top: W11 D12 H16  
 Center Top: W21 D12 H8  
 Bottom LSF: W17 D16 H14

**920-690**  
**BAR STOOL -**  
**COUNTER HEIGHT - KD**  
 W18 D21 H39  
 Seat H25



*Right:*  
**920-581**  
**END UNIT TOP**  
W24 D17 H44  
2 Adjustable Wooden Shelves,  
1 Fixed Shelf.  
(2 Shown)

**920-580**  
**END UNIT BASE**  
W24 D22 H31  
2 Doors with 2 Adjustable Half  
Shelves Behind Each.  
(2 Shown)

**920-592**  
**LIGHT BRIDGE**  
W51 D18 H3  
2 Can Light System.

**920-595**  
**DESK - RTA**  
W51 D22 H31  
1 Drawer with Removable  
Pencil Box, Power Bar Mounted  
in Top, Finished Back.

**920-941**  
**FILE/DRAWER CABINET**  
W16 D22 H24  
4 Casters, 2 Drawers,  
File Storage in  
Bottom Drawer.

**920-636**  
**SPLAT SIDE CHAIR**  
W20 D24 H39  
Seat H20





*Right & Below:*  
**920-945**  
**DROP LID WORK STATION**  
 W44 D21 H48  
 Drop Down Door,  
 LSF: 2 Drawers, Divided  
 Compartment,  
 Opening: W5 D13 H5,  
 Center: 1 Adjustable Shelf,  
 Opening: W14 D13 H16,  
 Power Bar, Wire Management,  
 RSF: 1 Drawer, Divided  
 Compartment,  
 Opening: W3 D13 H10,  
 4 Drawers, 2 Doors with  
 Removable Shelf Behind Each,  
 Wire Management,  
 File Storage in  
 Bottom Center Drawer.



*Above & Bottom Left:*  
**920-944**  
**HOME OFFICE CABINET**  
 W48 D25 H60  
 2 Doors, LSF: 1 Adjustable Shelf,  
 Top Opening: W27 D20 H24  
 1 Fixed Shelf, Pull Out Keyboard Tray,  
 Pull Out Printer Tray in Bottom, Cork  
 Board on Inside Door Panel.  
 Opening: W27 D20 H16  
 Power Bar.  
 RSF: 2 Adjustable Shelves,  
 Top Opening: W13 D20 H28  
 1 Fixed Shelf, 2 Drawers, Pencil Tray  
 in Top Drawer, File Storage in Bottom  
 Drawer, Wire Management, Magnetic  
 Dry Erase Board on Inside Door  
 Panel.

# CAMDEN

## LIGHT FINISH

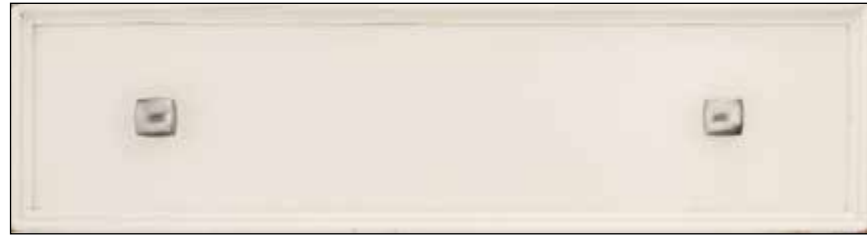

### 920 WHITE COLOR FINISH

#### POPLAR SOLIDS, MAPLE, ASH VENEERS AND SELECT HARDWOODS

Finishes ordered at different times are not guaranteed to match. Woods have grain and color variations due to growth patterns of each tree. The result is a beautiful and unique piece. Due to these variations, finishes on individual pieces are not guaranteed to match. The finish shown here has been reproduced as accurately as photographic and printing technologies allow.

For the truest representation, please contact your American Drew dealer.

## CARE & CLEANING

### CARE OF FINE FINISHES

American Drew finishes are naturally resistant to minor everyday hazards and accidents; however, some precautions are necessary to maintain the beauty of your wood furniture.

- Dust with a soft clean cloth slightly moistened with water, and then dry completely with another clean cloth. Always rub in the direction of the wood grain.
- Avoid cigarettes, hot dishes, moisture and harsh solvents such as nail polish and alcohol.
- Do not place beverages directly on furniture.
- Use pads beneath accessories when writing or eating.
- Remove spills and smudges immediately.
- Pliable materials should not be left on a wood surface; they can damage the finish.
- Furniture should not be placed near heat, outlets, windows, or in direct sunlight.

### CARE OF DECORATIVE HARDWARE

The decorative hardware on this furniture has been protected with a clear lacquer coat. The use of harsh detergents or brass polish in an attempt to clean or obtain higher luster will result in the removal of the protective lacquer and will damage the finish of the hardware. Use a soft damp cloth to remove dust.

All illustrations and specifications in this catalog are based on the latest product information available at the time of printing. American Drew reserves the right to discontinue items without notice and to make changes to colors, materials, equipment and specifications at any time. Quotes contained in this catalog are from fictional consumers. This catalog is intended to be distributed to authorized dealers, and possession does not constitute authority to purchase.

\* Indicates: Cannot be sold separately.  
"R" Indicates merchandise shipped in more than one carton and must be used to order complete item.

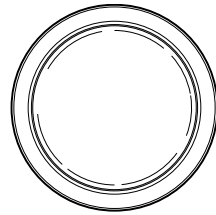

**920-015**  
**ROUND MIRROR**  
W39 D3 H39 (99 x 8 x 99cm)  
Beveled Mirror.  
Mirror Supports Not Included.  
Pages: 6, 12/13, 24/25, 26/27

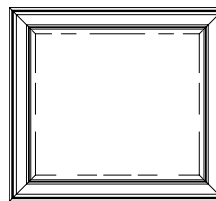

**920-020**  
**LANDSCAPE MIRROR**  
W41 D2 H36 (104 x 5 x 91cm)  
Beveled Mirror.  
Mirror Supports Not Included.  
Can be used vertical or horizontal.  
Page: 21

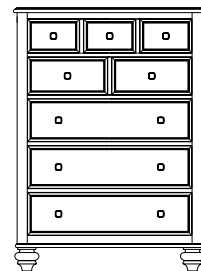

**920-215**  
**DRAWER CHEST**  
W38 D19 H52  
(97 x 48 x 132cm)  
5 Drawers.  
Page: 20

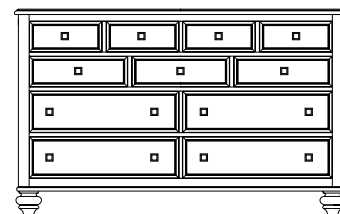

**920-220**  
**DRESSING CHEST**  
W62 D20 H39  
(157 x 51 x 99cm)  
9 Drawers.  
Page: 21

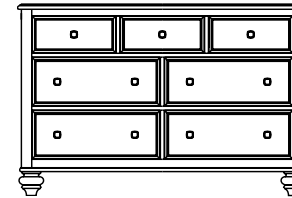

**920-221**  
**DRESSER**  
W56 D19 H37  
(142 x 48 x 94cm)  
7 Drawers.  
Pages: 24/25, 26/27

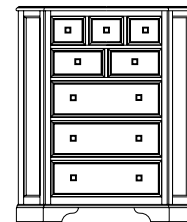

**920-230**  
**CORNER CHEST**  
W42 D20 H50  
(107 x 66 x 127cm)  
5 Drawers.  
Page: 20

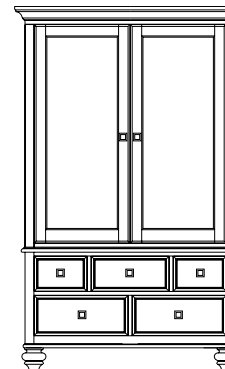

**920-270R**  
**ARMOIRE**  
W46 D24 H73  
(117 x 61 x 185cm)  
Consists of:  
**-271 Armoire Deck**  
W46 D24 H48  
(117 x 61 x 122cm)  
2 Wraparound Doors,  
2 Adjustable Shelves,  
Clothes Rod, Sliding Back  
Panel, 1 Fixed Shelf,  
2 Open Compartments:  
W19 D19 H6  
(48 x 48 x 15cm)  
TV Outlet Box.  
TV Opening:  
W39 D20 H37  
(99 x 51 x 94cm)  
**-270\* Armoire Base**  
W43 D22 H25  
(109 x 56 x 64cm)  
5 Drawers.  
Pages: 28/29

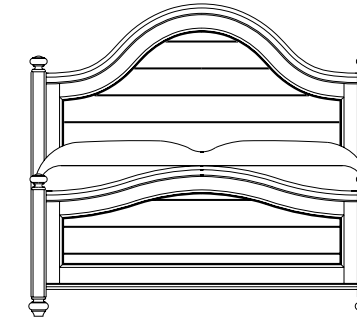

**920-310R**  
**PANEL BED 3/3**

Consists of:  
**-310 Panel Headboard 3/3**  
W43 D3 H53  
(109 x 8 x 135cm)  
Bored for Frame.  
**-311 Panel Footboard 3/3**  
W43 D3 H28  
(109 x 8 x 71cm)  
**-R40 Wood Rails with Slats 3/3**  
W76 D2 H8  
(193 x 5 x 20cm)  
Pages: 24/25

**920-313R**  
**PANEL BED 5/0**

Consists of:  
**-313 Panel Headboard 4/6 - 5/0**  
W65 D4 H62  
(165 x 10 x 157cm)  
Bored for Frame.  
**-314 Panel Footboard 4/6 - 5/0**  
W65 D4 H29  
(165 x 10 x 74cm)  
**-R42 Wooden Rails 5/0 - 6/6**  
W82 D2 H8  
(208 x 5 x 20cm)  
**-SK1 Mattress Support System**  
Pages: 18/19

Available in additional sizes:

**920-312R**  
**PANEL BED 4/6**

Consists of:  
**-313 Panel Headboard 4/6 - 5/0**  
W65 D4 H62  
(165 x 10 x 157cm)  
Bored for Frame.  
**-314 Panel Footboard 4/6 - 5/0**  
W65 D4 H29  
(165 x 10 x 74cm)  
**-R41 Wooden Rails 4/6**  
W76 D2 H8  
(193 x 5 x 20cm)  
**-SK1 Mattress Support System**

**920-316R**  
**PANEL BED 6/6**

Consists of:  
**-316 Panel Headboard 6/6 - 6/0**  
W83 D4 H66  
(211 x 10 x 168cm)  
Bored for Frame.  
**-317 Panel Footboard 6/6 - 6/0**  
W83 D4 H30  
(211 x 10 x 76cm)  
**-R42 Wooden Rails 5/0 - 6/6**  
W82 D2 H8  
(208 x 5 x 20cm)  
**-SK1 Mattress Support System**

**920-317R**  
**PANEL BED 6/0**

Consists of:  
**-316 Panel Headboard 6/0 - 6/6**  
W83 D4 H66  
(211 x 10 x 168cm)  
Bored for Frame.  
**-317 Panel Footboard 6/0 - 6/6**  
W83 D4 H30  
(211 x 10 x 76cm)  
**-R44 Wooden Rails 6/0**  
W86 D2 H8  
(218 x 5 x 20cm)  
**-SK1 Mattress Support System**

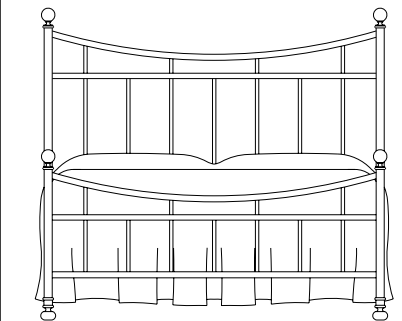

**920-390R**  
**METAL BED COMPLETE 3/3**  
**BRUSHED NICKEL FINISH**

Consists of:  
**-390 Metal Bed 3/3**  
W43 H58 Footboard H32 (81cm)  
(109 x 147cm)  
**-R90 Metal Rails 3/3**  
W76 D2 H8  
(193 x 5 x 20cm)  
Pages: 26/27

**920-395NR**  
**METAL BED 5/0 - BRUSHED NICKEL FINISH**

Consists of:  
**-395N Metal Bed 5/0**  
W65 H58 Footboard H32 (81cm)  
(102 x 102cm)  
**-R95N Metal Rails 5/0**  
W82 D2 H8  
(208 x 5 x 20cm)  
Pages: 22/23

Available in additional sizes:

**920-393NR**  
**METAL BED 4/6 - BRUSHED NICKEL FINISH**

Consists of:  
**-393N Metal Bed 4/6**  
W58 H58 Footboard H32 (81cm)  
(102 x 102cm)  
**-R93N Metal Rails 4/6**  
W76 D2 H8  
(193 x 5 x 20cm)

**920-398NR**  
**METAL BED 6/6 - BRUSHED NICKEL FINISH**

Consists of:  
**-398N Metal Bed 6/6**  
W81 H61 Footboard H34 (86cm)  
(206 x 155cm)  
**-R98N Metal Rails 6/6**  
W82 D2 H8  
(208 x 5 x 20cm)



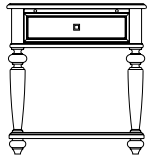

**920-401**  
**LEG NIGHTSTAND - RTA**  
 W26 D19 H28 (66 x 48 x 71cm)  
 1 Drawer, 1 Fixed Shelf,  
 Pull Out Shelf with Black Laminate.  
 Pages: 18/19, 22/23, 24/25,  
 26/27, 32

*Please use the following when  
 ordering frames and mirror supports:*  
**920-M71**  
**TWO MIRROR SUPPORTS**

**920-095**  
**METAL FRAME FOR 4/6 OR 5/0**  
**HEADBOARDS ONLY**

**920-096**  
**METAL FRAME FOR 6/6**  
**HEADBOARD ONLY**

**920-097**  
**METAL FRAME FOR 6/0**  
**HEADBOARD ONLY**

Chairs noted as shipped KD require  
 assembly.  
 -636 & -637 packed 2 per carton.  
 Service charge of \$10.00  
 for recartoning will apply when one chair  
 is ordered.  
 -690 & -691 packed 1 per carton.  
 COM ORDERS NOT ACCEPTED.

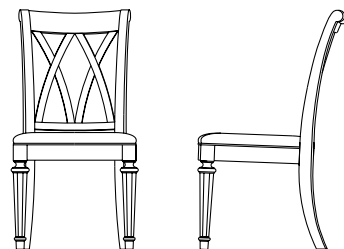

**920-636**  
**SPLAT SIDE CHAIR - KD**  
 W20 D24 H39 (51 x 61 x 99cm)  
 Seat H20 (51cm)  
 Pages: 3, 4/5, 12/13, 16, 42/43

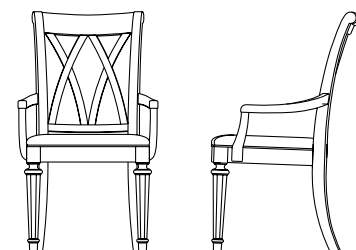

**920-637**  
**SPLAT ARM CHAIR - KD**  
 W23 D24 H39 (58 x 61 x 99cm)  
 Seat H20 (51cm)  
 Arm H25 (64cm)  
 Pages: 4/5, 16

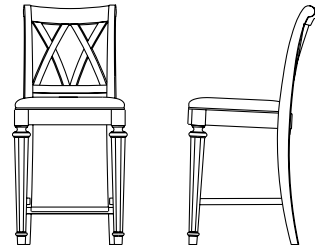

**920-690**  
**BAR STOOL - COUNTER HEIGHT - KD**  
 W18 D21 H39 (46 x 53 x 99cm)  
 Seat H25 (64cm)  
 Pages: 10/11, 14/15, 16, 41

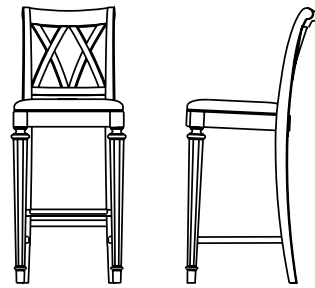

**920-691**  
**BAR STOOL - BAR HEIGHT - KD**  
 W18 D21 H45 (46 x 53 x 114cm)  
 Seat H30 (76cm)  
 Pages: 9, 16

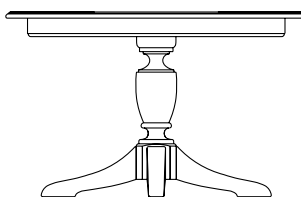

**920-701R**  
**ROUND LEG TABLE**  
 L48 W48 H30 (123 x 123 x 76cm)  
 (1) 16" (41cm) Leaf  
 Extends Table to 64" (163cm)  
*Consists of:*  
**-701 Round Table Top**  
 L48 W48 H4 (123 x 123 x 10cm)  
**-B01 Table Base**  
 W37 D37 H27 (94 x 94 x 69cm)  
 Pages: 12/13

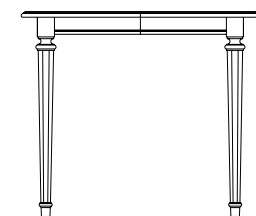

**920-705**  
**GATHERING TABLE - RTA**  
 L60 W42 H36 (152 x 107 x 91cm)  
 (1) 18" (46cm) Leaf  
 Extends Table to 60" (152cm)  
 Pages: 14/15

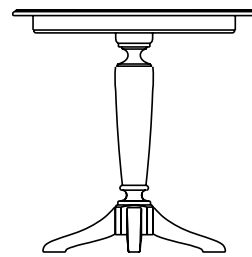

**920-706R**  
**ROUND BAR HEIGHT PED TABLE**  
 L42 W42 H41 (107 x 107 x 104cm)  
*Consists of:*  
**-706 Round Table Top**  
 L42 W42 H4 (107 x 107 x 10cm)  
**-B02 Bar Height Ped Table Base - RTA**  
 W32 D32 H40 (94 x 94 x 102cm)  
 Page: 9

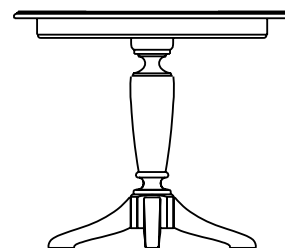

**920-707R**  
**ROUND COUNTER HEIGHT PED TABLE**  
 L42 W42 H35 (107 x 107 x 89cm)  
*Consists of:*  
**-706 Round Table Top**  
 L42 W42 H4 (107 x 107 x 10cm)  
**-B03 Counter Height Ped Table Base - RTA**  
 W32 D32 H34 (94 x 94 x 86cm)  
 Pages: 10/11

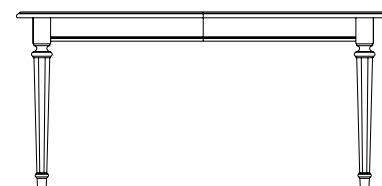

**920-760**  
**LEG TABLE - RTA**  
 L64 W42 H30 (163 x 107 x 76cm)  
 (1) 18" (46cm) Leaf  
 Extends Table to 82" (208cm)  
 Pages: 4/5

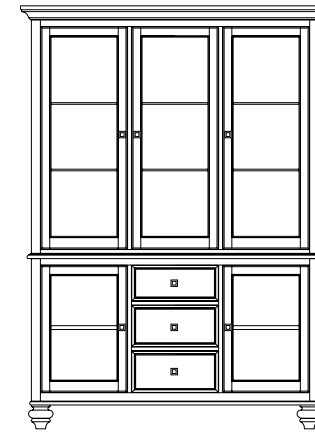

**920-830R**  
**CHINA**  
 W63 D20 H82 (160 x 51 x 208cm)  
*Consists of:*  
**-831 China Deck**  
 W63 D20 H48 (160 x 51 x 122cm)  
 3 Doors, 6 Adjustable Glass Shelves, 3  
 Can Lights, Mirrored Back, Touch  
 Lighting.  
 Pages: 4/5, 7

**-830 China Buffet/Credenza**  
 W60 D19 H34 (152 x 48 x 86cm)  
 2 Glass Doors with 1 Adjustable Glass  
 Shelf in Each, 3 Drawers, Silver Tray, 2  
 Can Lights, Touch Lighting.  
 Pages: 4/5, 7

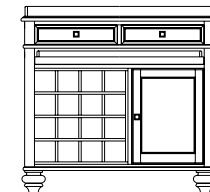

**920-890**  
**SERVER**  
 W40 D18 H38 (102 x 46 x 97cm)  
 2 Drawers, 1 Pullout Shelf,  
 1 Door with 1 Adjustable Shelf,  
 Stationary Wine Storage, Silver Tray.  
 Pages: 6, 10/11, 12/13

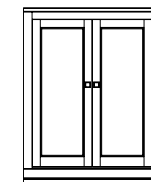

**920-580**  
**END UNIT BASE**  
 W24 D22 H31  
 (61 x 56 x 79cm)  
 2 Doors with 2 Adjustable Half Shelves  
 Behind Each.  
 Pages: 36/37, 42/43

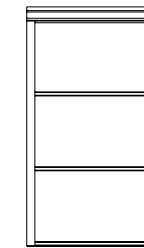

**920-581**  
**END UNIT TOP**  
 W24 D17 H44  
 (61 x 43 x 112cm)  
 2 Adjustable Wooden Shelves,  
 1 Fixed Shelf.  
 Pages: 36/37, 42/43

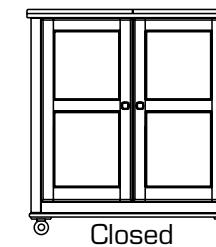

Closed

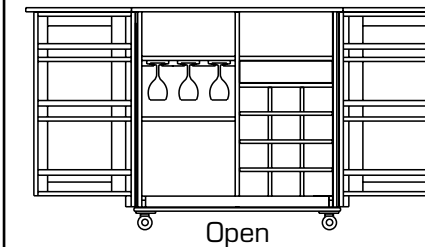

Open

**920-582**  
**FLIP TOP BAR**  
 W39 D22 H43  
 (99 x 56 x 109cm)  
 2 Doors, Bottle Storage, 1 Drawer, Wine  
 Storage, Black Laminate on Flip Top,  
 Casters on Bottom.  
 TOP LSF: W17 D16 H18  
 (43 x 41 x 46cm)  
 TOP RSF: W17 D16 H8  
 (43 x 41 x 20cm)  
 BOTTOM LSF: W17 D16 H14  
 (43 x 41 x 36cm)

Page: 8

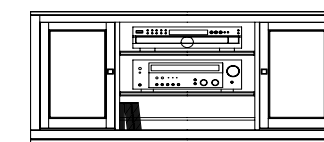

**920-583**  
**64" ENTERTAINMENT CENTER**  
 W64 D22 H25  
 (163 x 56 x 64cm)  
 2 Doors with Fixed Half Shelf  
 Behind Each, 2 Adjustable Shelves  
 and 1 Fixed Shelf in Center.  
 Pages: 36/37

**920-584**  
**51" ENTERTAINMENT CENTER**  
 W51 D22 H25  
 (130 x 56 x 64cm)  
 2 Doors with Fixed Half Shelf  
 Behind Each, 2 Adjustable Shelves  
 and 1 Fixed Shelf in Center.  
 Not Shown. Reference pages 36/37.

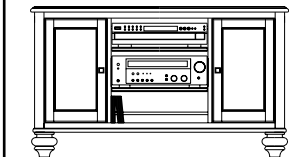

**920-585**  
**48" ENTERTAINMENT CENTER**  
 W48 D24 H28  
 (123 x 61 x 71cm)  
 2 Doors with Adjustable Shelf  
 Behind Each, 2 Adjustable Shelves  
 and 1 Fixed Shelf in Center.  
 Page: 34

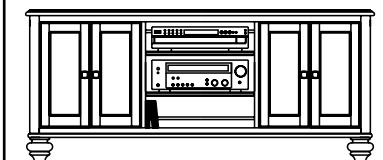

**920-586**  
**64" ENTERTAINMENT CENTER**  
 W64 D24 H28  
 (163 x 61 x 71cm)  
 2 Double Doors with 1 Adjustable Shelf  
 Behind Each, 2 Adjustable Shelves  
 and 1 Fixed Shelf in Center.  
 Opening Behind Doors:  
 W19 D21 H19 (48 x 53 x 48cm)  
 Center Opening:  
 W20 D21 H19 (51 x 53 x 48cm)  
 Page: 38

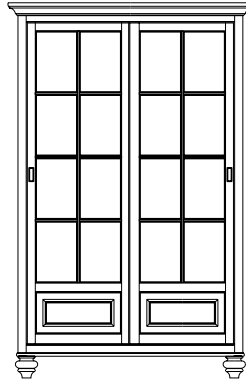

**920-588**  
**BOOKCASE/CHINA**  
 W52 D19 H80  
 (132 x 48 x 203cm)  
 2 Sliding Doors, 2 Tray Drawers, 3  
 Adjustable Glass Shelves, 2 Can Lights.  
 Pages: 14/15, 35

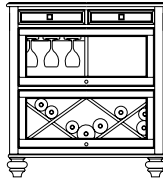

**920-589**  
**BOOKCASE/BAR**  
 W38 D18 H42  
 (97 x 46 x 107cm)  
 2 Drawers, Glass Fold Up Door  
 with Wine Glass Storage on LSF,  
 Open Compartment on RSF, Glass Fold  
 Up Door with Removable Wine Rack  
 on Bottom.  
 Page: 17



**920-590**  
**51" STORAGE BRIDGE**  
 W51 D17 H14 (130 x 43 x 36cm)  
 3 Open Compartments.  
 Left & Right Outsides:  
 W12 D16 H10 (30 x 41 x 25cm)  
 Center:  
 W24 D16 H10 (61 x 41 x 25cm)  
 Not Shown. Reference pages 36/37.



**920-591**  
**64" STORAGE BRIDGE**  
 W64 D17 H14 (163 x 43 x 36cm)  
 3 Open Compartments.  
 Left & Right Outsides:  
 W17 D16 H10 (43 x 41 x 25cm)  
 Center:  
 W28 D16 H10 (71 x 41 x 25cm)  
 Pages: 36/37



**920-592**  
**LIGHT BRIDGE**  
 W51 D18 H3  
 (130 x 46 x 8cm)  
 2 Can Light System.  
 Pages: 42/43

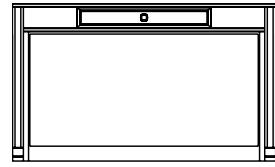

**920-595**  
**DESK - RTA**  
 W51 D22 H31  
 (130 x 56 x 79cm)  
 1 Drawer with Removable Pencil Box,  
 Power Bar Mounted in Top, Finished Back.  
 Pages: 3, 42/43

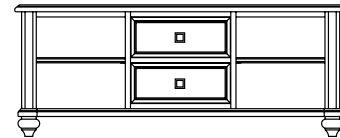

**920-910**  
**COCKTAIL TABLE**  
 W48 D24 H19  
 (122 x 61 x 48cm)  
 2 Pull Through Drawers,  
 4 Baskets.  
 Pages: 30/31



**920-915**  
**SIDE TABLE**  
 W23 D20 H25  
 (58 x 51 x 64cm)  
 2 Drawers, 1 Basket.  
 Pages: 30/31, 32

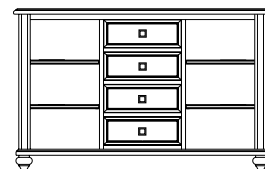

**920-925**  
**CONSOLE TABLE**  
 W48 D16 H30  
 (122 x 41 x 76cm)  
 4 Drawers, 4 Baskets,  
 2 Adjustable Shelves.  
 Page: 33

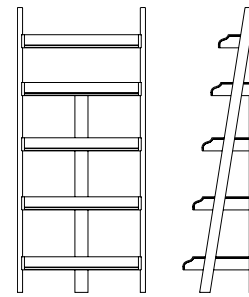

**920-940**  
**WALL STORAGE - RTA**  
 W34 D19 H76  
 (86 x 48 x 193cm)  
 5 Shelves.  
 Pages: 34, 39

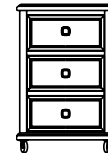

**920-941**  
**FILE/DRAWER CABINET**  
 W16 D22 H24  
 (41 x 56 x 61cm)  
 4 Casters, 2 Drawers, File Storage in  
 Bottom Drawer.  
 Pages: 42/43

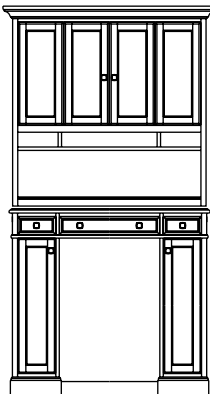

**920-942**  
**HOME WORK STATION**  
 W48 D23 H39  
 (122 x 58 x 99cm)  
 3 Drawers, Fold Down Front Center  
 Drawer, Pencil Tray, Power Bar, 2 Doors  
 with 3 Tray Drawers Behind Each, File  
 Storage in Each Bottom Drawer.  
 Pages: 38/39

**920-943**  
**HOME WORK STATION DECK**  
 W51 D15 H44  
 (130 x 38 x 112cm)  
 4 Bi-Fold Doors with 3 Adjustable Shelves,  
 Removable Charging Station, Power Bar,  
 Wire Management. Openings:  
 Top: W11 D12 H16  
 (28 x 30 x 41cm)  
 Center Top: W21 D12 H8  
 (53 x 30 x 20cm)  
 Bottom LSF: W17 D16 H14  
 (43 x 41 x 36cm)  
 Pages: 40/41

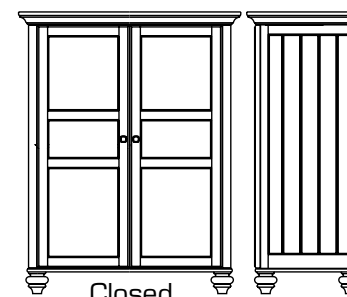

Closed

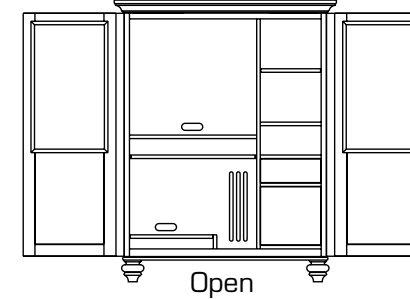

Open

**920-944**  
**HOME OFFICE CABINET**  
 W48 D25 H60  
 (122 x 64 x 152cm)  
 2 Doors, LSF: 1 Adjustable Shelf Top,  
 Opening: W27 D20 H24  
 (69 x 51 x 61cm)  
 1 Fixed Shelf, Pull Out Keyboard Tray,  
 Pull Out Printer Tray in Bottom.  
 Opening: W27 D20 H16  
 (69 x 51 x 41cm)  
 Power Bar, Cork Board on Inside Door Panel.  
 RSF: 2 Adjustable Shelves,  
 Top Opening: W13 D20 H28  
 (33 x 51 x 71cm)  
 1 Fixed Shelf, 2 Drawers, Pencil Tray in  
 Top Drawer, File Storage in Bottom  
 Drawer, Wire Management, Magnetic  
 Dry Erase Board on Inside Door Panel.  
 Page: 44

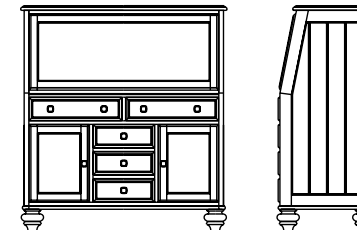

**920-945**  
**DROP LID WORK STATION**  
 W44 D21 H48  
 (112 x 53 x 122cm)  
 Drop Down Door, LSF: 2 Drawers, Divided  
 Compartment,  
 Opening: W5 D13 H5 (13 x 33 x 13cm),  
 Center: 1 Adjustable Shelf,  
 Opening: W14 D13 H16 (36 x 33 x 41cm),  
 Power Bar, Wire Management,  
 RSF: 1 Drawer, Divided Compartment,  
 Opening: W3 D13 H10 (8 x 33 x 25cm),  
 4 Drawers, 2 Doors with Removable Shelf  
 Behind Each, Wire Management, File  
 Storage in Bottom Center Drawer.  
 Page: 44/45

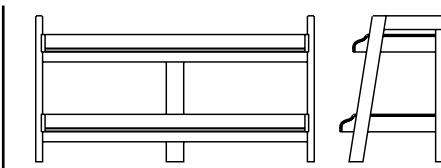

**920-946**  
**56" ENTERTAINMENT CENTER - RTA**  
 W56 D23 H29 (142 x 58 x 74cm)  
 2 Fixed Shelves,  
 Top Opening: W52 D19 H7  
 (132 x 48 x 18cm)  
 Bottom Opening: W52 D22 H13  
 (132 x 56 x 33cm)  
 Page: 39